

| TENANT NAME            | UNIT NO | SANCTION AREA (SQ.FT) | PROPOSED AREA (SQ.FT) |
|------------------------|---------|-----------------------|-----------------------|
| BUJAYA KUMAR SAHOO     | 2001    |                       | 232                   |
| BBWL                   | 2001A   |                       | 221                   |
| PROMISING EXPORTS LTD. | 2002    | 5022                  | 4984                  |
| PROMISING EXPORTS LTD. | 2002A   |                       | 50                    |
| VILAYA BANK            | 2003    |                       | 2369                  |
| VILAYA BANK            | 2003A   | 4462                  | 2094                  |

THIS DRAWING IS A PRIVATE AND CONFIDENTIAL COMMUNICATION AND THE PROPERTY OF MANIRAMKA AND ASSOCIATES AND MUST NOT BE COPIED OR LENT WITHOUT THE CONSENT OF MANIRAMKA AND ASSOCIATES.

STRUCTURE SHOWN IN YELLOW FIRM LINE ARE SANCTIONED & SHALL BE CONSTRUCTED.

STRUCTURE SHOWN IN YELLOW DOTTED LINE ARE SANCTIONED BUT SHALL NOT BE CONSTRUCTED.

STRUCTURE SHOWN IN RED HATCH ARE NOT SANCTIONED BUT PROPOSED FOR CONSTRUCTION.

#### DECLARATION

#### CERTIFICATE OF ARCHITECT

I CERTIFY WITH FULL RESPONSIBILITY THAT THE BUILDING PLAN HAS BEEN DRAWN AS PER PROVISION OF K.M.C. BUILDING RULE 2009 AS AMENDED FROM TIME TO TIME AND THE SITE CONDITION INCLUDING WIDTH OF THE ABUTTING ROAD (51.268 MT.) CONFORMS WITH THE PLAN WHICH HAS BEEN MEASURED & VERIFIED BY ME. IT IS A BUILDABLE SITE NOT A TANK OR FILLED UP TANK. THE LAND IS DEMARCATED BY BOUNDARY WALL. EXISTING STRUCTURE SHALL BE DEMOLISHED BEFORE COMMENCEMENT OF THE CONSTRUCTION WHICH IS FULLY OCCUPIED BY THE OWNER & TENANTS.

*Sunil Maniramka*  
SUNIL MANIRAMKA, (B.Arch.)  
Consulting Architect  
Council of Architecture (Regn. No. CA/5015638)

SIG. OF ARCHITECT

#### CERTIFICATE OF STRUCTURAL ENGINEER

THE STRUCTURAL DESIGN & DRAWING OF THE BOTH FOUNDATION AND SUPER STRUCTURE OF THE BUILDING HAS BEEN MADE BY ME CONSIDERING ALL THE POSSIBLE LOADS INCLUDING SEISMIC LOAD AS PER THE NATIONAL BUILDING CODE OF INDIA AND CERTIFY THAT IT IS SAFE, STABLE IN ALL RESPECT. SOIL TESTING REPORT HAS BEEN DONE BY SGM GEOSURVEY, BK-30, SAILLAKH, KOLKATA-700091. THE RECOMMENDATION OF REPORT HAS BEEN CONSIDERED DURING STRUCTURAL CALCULATION.

*Sanjiv P. B. B. B.*  
SANJIV P. B. B. B.  
M.E. (STR. & C.E.) (CONST. ENGR.)  
R.C.E., FIE (F-118202-4)  
E.S.E. No. 104 (I) K.M.C.

SIG. OF STR. ENGINEER

#### CERTIFICATE OF STRUCTURAL REVIEWER

THIS IS TO CERTIFY THAT I HAVE REVIEWED THE STRUCTURAL DESIGN OF PROPOSED PREMISES CONSIDERING ALL POSSIBLE LOADS INCLUDING SEISMIC LOAD AS PER PROVISION OF RELEVANT S CODE AND IT IS ALSO CERTIFIED THAT THE BUILDING IS SAFE AND STABLE IN ALL RESPECT.

*SKANJIB GUHA*  
SKANJIB GUHA  
BSC, BOC, FIE (F-115654-5)  
CHARTERED ENGINEER  
ENLISTED STRUCTURAL  
REVIEWER 8818 K.M.C.

SIG. OF STR. REVIEWER

#### CERTIFICATE OF THE GEO-TECHNICAL ENGINEER

IT IS CERTIFIED THAT THE COMPREHENSIVE GEO-TECHNICAL REPORT ON SOIL INVESTIGATION HAS BEEN PREPARED BY ME FOR DESIGN AND CALCULATION OF THE FOUNDATION BY ANALYZING THE SOIL SAMPLE FOR ESTIMATING THE BEARING CAPACITY OF THE SOIL ON WHICH FOUNDATION OF THE STRUCTURE WILL BE CONSTRUCTED. I SHALL ALSO CHECK THE NATURE OF THE SOIL AFTER EXCAVATION AT SITE SO THAT FOUNDATION IS EXTENDED UP TO APPROPRIATE DEPTH THAT HAS BEEN PROPOSED IN THE GEO-TECHNICAL REPORT.

*JITENDRA K. GUHA*  
JITENDRA K. GUHA  
B.Tech (Civil), M.B. (Geo-Tech)  
HMC Reg. No. G/17/32  
22/12/2018/G-1/2016-17  
HMC Reg. No. 6578/CLASS-1/15

SIG. OF GEO-TECHNICAL ENGINEER

#### CERTIFICATE OF OWNER

WE DO HEREBY UNDERTAKE WITH FULL RESPONSIBILITY THAT -  
1) WE SHALL ENGAGE L.B.A. & E.S.E. DURING CONSTRUCTION.  
2) WE SHALL FOLLOW THE INSTRUCTION OF L.B.A. & E.S.E. DURING CONSTRUCTION OF THE BUILDING (AS PER B.S. PLAN).  
3) K.M.C. AUTHORITY WILL NOT BE RESPONSIBLE FOR STRUCTURAL STABILITY OF THE BUILDING & ADJOINING STRUCTURE.  
4) IF ANY SUBMITTED DOCUMENTS ARE FOUND TO BE FAKE, THE K.M.C. AUTHORITY WILL REVOKE THE SANCTION PLAN.  
5) THE CONSTRUCTION OF WATER RESERVOIR AND SEPTIC TANK WILL BE UNDER THE GUIDANCE OF L.B.A. / E.S.E. BEFORE STARTING OF BUILDING FOUNDATION WORK.

For Bengal Bonded Warehouse Limited  
*Director*  
Director.  
SIG. OF OWNER

AMENDED PLAN OF PROPOSED G+39 (155.00 MT HT.) STORED 'MEGA COMMERCIAL PROJECT' AT PREMISES NO: 25, NETAJI SUBHAS ROAD, WARD NO - 45, BOROUGH - V, P.S. - HARE STREET, KOLKATA - 700001, UNDER KOLKATA MUNICIPAL CORPORATION. AS PER SECTION 412A OF KOLKATA MUNICIPAL CORPORATION ACT 1980. READ WITH SECTION 394 OF KMC ACT 1980 ALONG WITH RULE 26 (2a & 2b) OF KMC BUILDING RULE 2009

PREVIOUS KMC SANCTION PERMIT NO : 2023050011 DATED : 21.07.2023 FOR BUILDING HEIGHT (G+32) 127.20 MT

#### SANCTION DRAWING

#### 20TH FLOOR PLAN

STRUCTURAL ENGINEER : SPA CONSULTANTS (SPA)  
34 RAJMOHAN DUTTA ROAD, KOLKATA-700020  
WEST BENGAL, INDIA  
Email: spa\_cons@yahoo.co.in

DATE: 26.03.2024 SCALE: 1:100 (DET: MAHUA) (DRG NO-25 N.S. ROAD/SD/21)

ARCHITECTS : MANIRAMKA AND ASSOCIATES  
74 B.A. J. C. BOSE ROAD, KOLKATA-700 016  
PHONE : (033) 2217 8329  
E mail: maniramka.associates@gmail.com  
www.maniramkaarchitect.com

SHEET 21

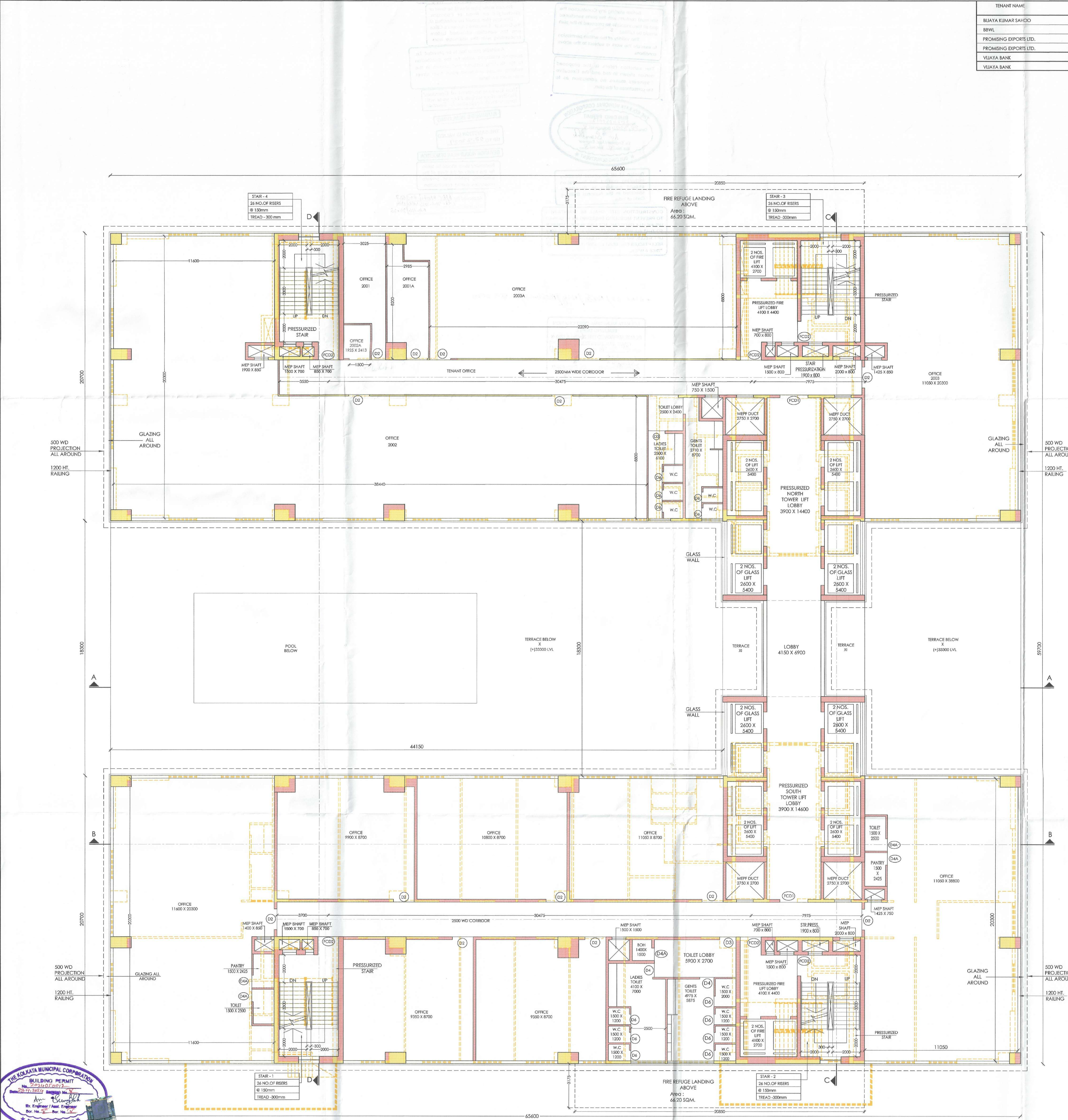
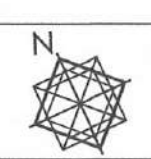



# PARTY'S COPY

20th Floor Plan

| Sl. No. | Particulars | Unit | Quantity | Rate | Amount |
|---------|-------------|------|----------|------|--------|
| 1       | ...         | ...  | ...      | ...  | ...    |
| 2       | ...         | ...  | ...      | ...  | ...    |
| 3       | ...         | ...  | ...      | ...  | ...    |
| 4       | ...         | ...  | ...      | ...  | ...    |
| 5       | ...         | ...  | ...      | ...  | ...    |
| 6       | ...         | ...  | ...      | ...  | ...    |
| 7       | ...         | ...  | ...      | ...  | ...    |
| 8       | ...         | ...  | ...      | ...  | ...    |
| 9       | ...         | ...  | ...      | ...  | ...    |
| 10      | ...         | ...  | ...      | ...  | ...    |
| 11      | ...         | ...  | ...      | ...  | ...    |
| 12      | ...         | ...  | ...      | ...  | ...    |
| 13      | ...         | ...  | ...      | ...  | ...    |
| 14      | ...         | ...  | ...      | ...  | ...    |
| 15      | ...         | ...  | ...      | ...  | ...    |
| 16      | ...         | ...  | ...      | ...  | ...    |
| 17      | ...         | ...  | ...      | ...  | ...    |
| 18      | ...         | ...  | ...      | ...  | ...    |
| 19      | ...         | ...  | ...      | ...  | ...    |
| 20      | ...         | ...  | ...      | ...  | ...    |
| 21      | ...         | ...  | ...      | ...  | ...    |
| 22      | ...         | ...  | ...      | ...  | ...    |
| 23      | ...         | ...  | ...      | ...  | ...    |
| 24      | ...         | ...  | ...      | ...  | ...    |
| 25      | ...         | ...  | ...      | ...  | ...    |
| 26      | ...         | ...  | ...      | ...  | ...    |
| 27      | ...         | ...  | ...      | ...  | ...    |
| 28      | ...         | ...  | ...      | ...  | ...    |
| 29      | ...         | ...  | ...      | ...  | ...    |
| 30      | ...         | ...  | ...      | ...  | ...    |
| 31      | ...         | ...  | ...      | ...  | ...    |
| 32      | ...         | ...  | ...      | ...  | ...    |
| 33      | ...         | ...  | ...      | ...  | ...    |
| 34      | ...         | ...  | ...      | ...  | ...    |
| 35      | ...         | ...  | ...      | ...  | ...    |
| 36      | ...         | ...  | ...      | ...  | ...    |
| 37      | ...         | ...  | ...      | ...  | ...    |
| 38      | ...         | ...  | ...      | ...  | ...    |
| 39      | ...         | ...  | ...      | ...  | ...    |
| 40      | ...         | ...  | ...      | ...  | ...    |
| 41      | ...         | ...  | ...      | ...  | ...    |
| 42      | ...         | ...  | ...      | ...  | ...    |
| 43      | ...         | ...  | ...      | ...  | ...    |
| 44      | ...         | ...  | ...      | ...  | ...    |
| 45      | ...         | ...  | ...      | ...  | ...    |
| 46      | ...         | ...  | ...      | ...  | ...    |
| 47      | ...         | ...  | ...      | ...  | ...    |
| 48      | ...         | ...  | ...      | ...  | ...    |
| 49      | ...         | ...  | ...      | ...  | ...    |
| 50      | ...         | ...  | ...      | ...  | ...    |
| 51      | ...         | ...  | ...      | ...  | ...    |
| 52      | ...         | ...  | ...      | ...  | ...    |
| 53      | ...         | ...  | ...      | ...  | ...    |
| 54      | ...         | ...  | ...      | ...  | ...    |
| 55      | ...         | ...  | ...      | ...  | ...    |
| 56      | ...         | ...  | ...      | ...  | ...    |
| 57      | ...         | ...  | ...      | ...  | ...    |
| 58      | ...         | ...  | ...      | ...  | ...    |
| 59      | ...         | ...  | ...      | ...  | ...    |
| 60      | ...         | ...  | ...      | ...  | ...    |
| 61      | ...         | ...  | ...      | ...  | ...    |
| 62      | ...         | ...  | ...      | ...  | ...    |
| 63      | ...         | ...  | ...      | ...  | ...    |
| 64      | ...         | ...  | ...      | ...  | ...    |
| 65      | ...         | ...  | ...      | ...  | ...    |
| 66      | ...         | ...  | ...      | ...  | ...    |
| 67      | ...         | ...  | ...      | ...  | ...    |
| 68      | ...         | ...  | ...      | ...  | ...    |
| 69      | ...         | ...  | ...      | ...  | ...    |
| 70      | ...         | ...  | ...      | ...  | ...    |
| 71      | ...         | ...  | ...      | ...  | ...    |
| 72      | ...         | ...  | ...      | ...  | ...    |
| 73      | ...         | ...  | ...      | ...  | ...    |
| 74      | ...         | ...  | ...      | ...  | ...    |
| 75      | ...         | ...  | ...      | ...  | ...    |
| 76      | ...         | ...  | ...      | ...  | ...    |
| 77      | ...         | ...  | ...      | ...  | ...    |
| 78      | ...         | ...  | ...      | ...  | ...    |
| 79      | ...         | ...  | ...      | ...  | ...    |
| 80      | ...         | ...  | ...      | ...  | ...    |
| 81      | ...         | ...  | ...      | ...  | ...    |
| 82      | ...         | ...  | ...      | ...  | ...    |
| 83      | ...         | ...  | ...      | ...  | ...    |
| 84      | ...         | ...  | ...      | ...  | ...    |
| 85      | ...         | ...  | ...      | ...  | ...    |
| 86      | ...         | ...  | ...      | ...  | ...    |
| 87      | ...         | ...  | ...      | ...  | ...    |
| 88      | ...         | ...  | ...      | ...  | ...    |
| 89      | ...         | ...  | ...      | ...  | ...    |
| 90      | ...         | ...  | ...      | ...  | ...    |
| 91      | ...         | ...  | ...      | ...  | ...    |
| 92      | ...         | ...  | ...      | ...  | ...    |
| 93      | ...         | ...  | ...      | ...  | ...    |
| 94      | ...         | ...  | ...      | ...  | ...    |
| 95      | ...         | ...  | ...      | ...  | ...    |
| 96      | ...         | ...  | ...      | ...  | ...    |
| 97      | ...         | ...  | ...      | ...  | ...    |
| 98      | ...         | ...  | ...      | ...  | ...    |
| 99      | ...         | ...  | ...      | ...  | ...    |
| 100     | ...         | ...  | ...      | ...  | ...    |

## DECLARATION

I, the undersigned, being the owner of the property, hereby declare that the above plan is a true and correct representation of the actual state of the property and that the same is in conformity with the provisions of the Building Rules, 1980, of the Corporation of Kolkata.

Signed and sealed at Kolkata, this 1st day of 12, 2024.

Signature of the owner

Signature of the architect

Signature of the structural engineer

Signature of the electrical engineer

Signature of the mechanical engineer

Signature of the civil engineer

Signature of the sanitary engineer

Signature of the fire engineer

Signature of the lift engineer

Signature of the drainage engineer

Signature of the ventilation engineer

Signature of the lighting engineer

Signature of the heating engineer

Signature of the cooling engineer

Signature of the power engineer

Signature of the communication engineer

Signature of the security engineer

Signature of the fire alarm engineer

Signature of the lift alarm engineer

Signature of the drainage alarm engineer

Signature of the ventilation alarm engineer

Signature of the lighting alarm engineer

Signature of the heating alarm engineer

Signature of the cooling alarm engineer

Signature of the power alarm engineer

Signature of the communication alarm engineer

Signature of the security alarm engineer

Signature of the fire alarm alarm engineer

Signature of the lift alarm alarm engineer

Signature of the drainage alarm alarm engineer

Signature of the ventilation alarm alarm engineer

Signature of the lighting alarm alarm engineer

Signature of the heating alarm alarm engineer

Signature of the cooling alarm alarm engineer

Signature of the power alarm alarm engineer

Signature of the communication alarm alarm engineer

Signature of the security alarm alarm engineer

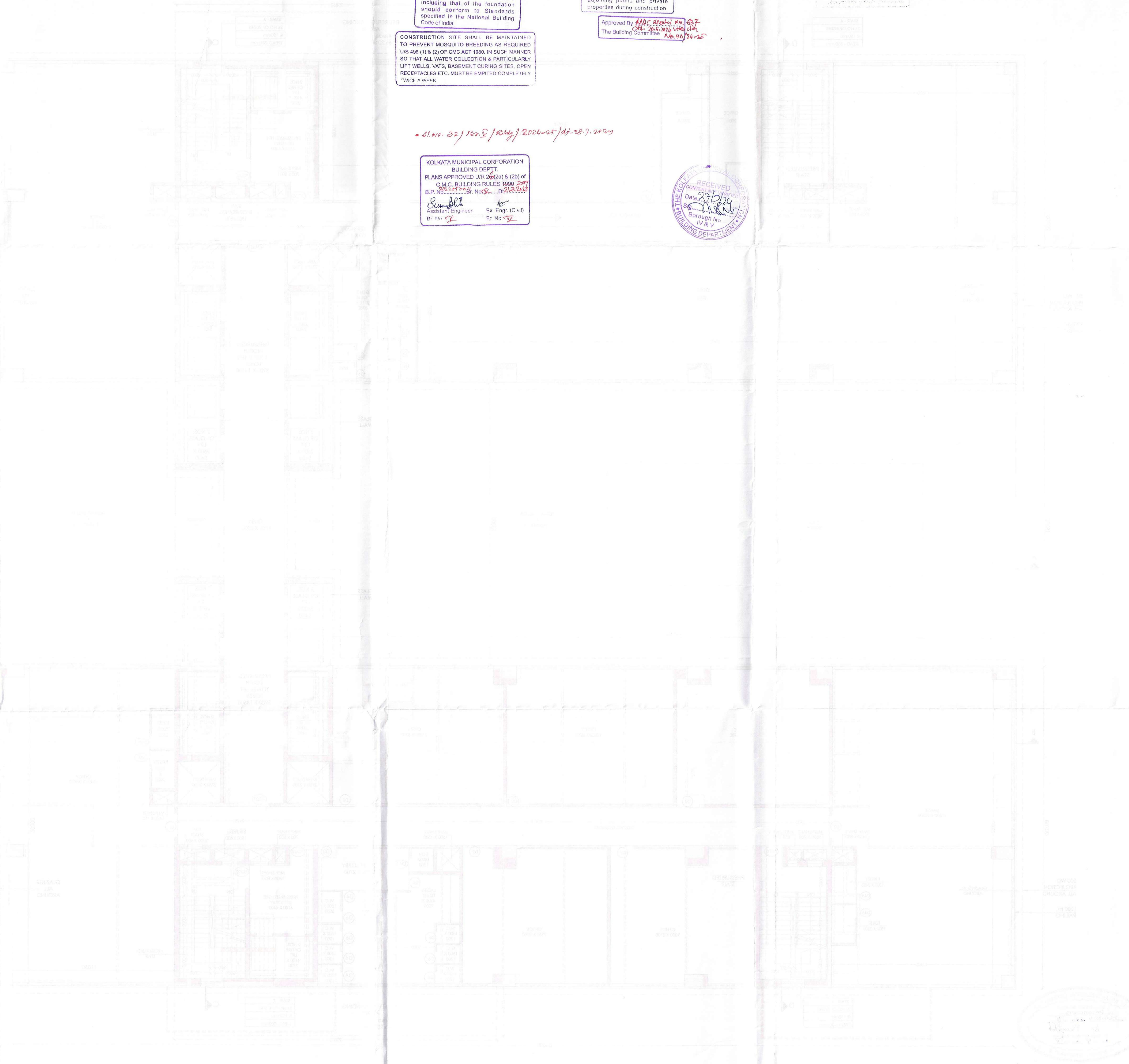

Sl. No. 32 / 100 / 104 / 2024-05 / dt-28.9.2024

KOLKATA MUNICIPAL CORPORATION  
BUILDING DEPT.  
PLANS APPROVED U/R 26(2a) & (2b) of  
C.M.C. BUILDING RULES 1980 2017  
B.P. No. 32 / 100 / 104 / 2024-05  
Date 28.9.2024  
Signature of the Engineer  
Assistant Engineer  
Signature of the Engineer  
Ex Engr (Civl)  
B- No. 32



Plan for Water Supply arrangement including  
SEMI G. & O. H. reservoirs should be  
submitted at the Office of the Ex-Engineer Water  
Supply and the sanction obtained before  
proceeding with the work of Water Supply any  
deviation may lead to disconnection/demolition.

Before starting any Construction the  
site must conform with the plans sanctioned  
and all the conditions as proposed in the plan  
should be fulfilled.  
The validity of the written permission  
to execute the work is subject to the above  
conditions.

The sanction refers to the proposed  
portion shown in red and the Executive  
Engineers makes no admission as to  
the correctness of the plan.

The building materials that will be  
stacked on Road/Passage or Foot-path  
beyond 3-months or after construction  
of G. Floor, whichever is earlier may be  
seized forthwith by the K.M.C. at the  
cost and risk of the owner.

No rain water pipe should be laid or  
discharged on Road or Footpath.  
Drainage plan should be submitted at  
the Borough Executive Engineer's Office  
and the sanction obtained before  
proceeding with the drainage work.

A suitable pump has to be provided i.e.  
pumping unfiltered water for the distribution  
to the flushing cisterns and urinals in the  
building incase unfiltered water from street  
main is not available.

Non Commencement of Erection/  
Re-Erection within Five year will  
Require Fresh Application for Sanction

BUSINESS BUILDING

THE SANCTION IS VALID  
UP TO 27.9.2025

DEVIATION WOULD MEAN DEMOLITION

Necessary steps should be taken  
for the safety of the lives of the  
adjoining public and private  
properties during construction

Approved By *AJDC Meeting No. 67*  
The Building Committee  
Date 28.9.2024  
No. 44/20-25

